

# Push-Pull Toggle Clamp

Part No. GH-36330M

**GH GoodHand UK**

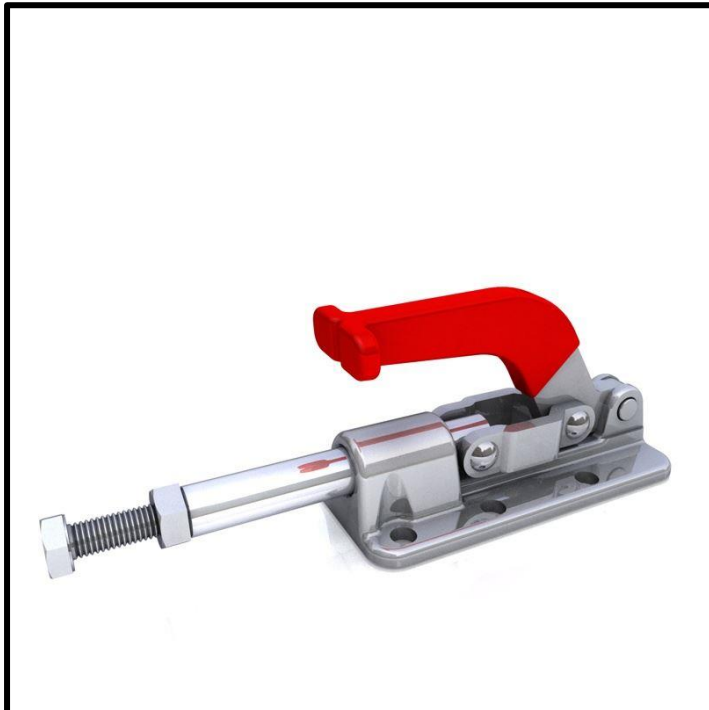

## Product Description

Push Pull Toggle Clamp Plunger  
Stroke 50.8mm Size 1136Kg

## Key Features

Overall Height: 74.9mm  
Length: 181.5mm  
Stroke: 50.8mm  
Holding Force: 1136Kg

## Other Features

Arm Opens: 180°  
Weight: 0.966Kg

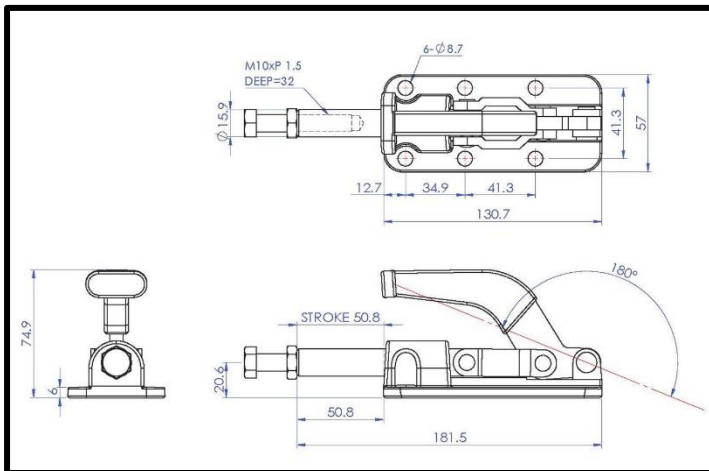

## Material

Clamp: Zinc Plated Mild Steel  
Spindle: Zinc Plated Mild Steel  
Handle: uPVC

## What's In The Bag?

GH-36330M: Toggle Clamp  
SA-105015: M10x50mm Zinc Plated Steel Spindle  
With Nut

**GH GoodHand UK**

[goodhanduk.co.uk](http://goodhanduk.co.uk)

01908 221 151