

Vertical Toggle Clamp

Part No. GH-13502-B

GH GoodHand UK



Product Description

Vertical Toggle Clamp Flat Base
Slotted Arm Size 350Kg

Key Features

Overall Height: 220.4mm
Underarm Height: 42mm
Arm Length: 82.8mm
Holding Force: 350Kg

Other Features

Arm Opens: 90°
Handle Opens: 70°
Weight: 0.89Kg

Material

Clamp: Zinc Plated Mild Steel
Spindle: Zinc Plated Mild Steel
Handle: uPVC

What's In The Bag?

GH-13502-B: Toggle Clamp
2x FW-380: Flanged Washers For 10mm Spindle
SA-107515: M10x75mm Zinc Plated Steel Spindle
With Nuts

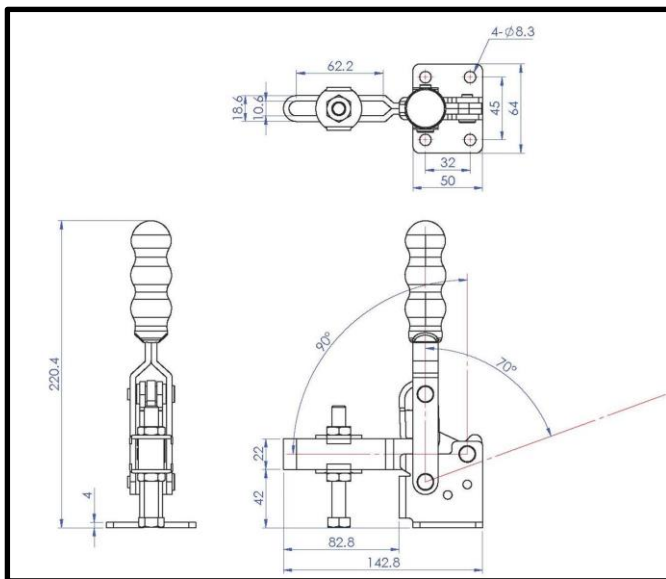

GH GoodHand UK

goodhanduk.co.uk

01908 221 151