

Horizontal Toggle Clamp

Part No. GH-23502-B



Product Description

Horizontal Toggle Clamp Flat
Base Slotted Arm Size 350daN

Key Features

Overall Height:	90.1mm
Underarm Height:	45mm
Arm Length	108mm
Holding Force	350daN

Other Features

Arm Opens:	90°
Handle Opens:	72°
Weight:	0.955Kg

Material

Toggle Clamp:	Zinc Plated Mild Steel
Spindle:	Zinc Plated Mild Steel
Handle:	uPVC

Whats In The Bag?

Toggle Clamp:	GH-20235
Spindle:	SA-107515
2x Flanged Washers:	FW-380

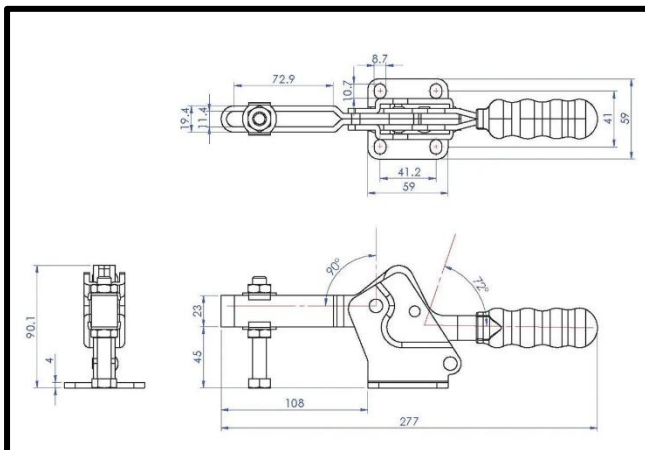

goodhanduk.co.uk

01908 221 151