

Horizontal Toggle Clamp

Part No. GH-201-BSS

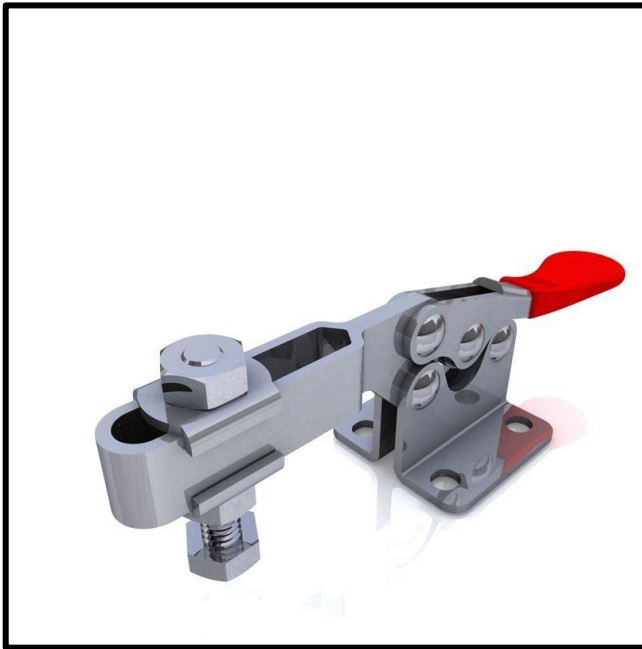

Product Description

Stainless Steel Horizontal Clamp
Flat Base Size 90daN

Key Features

Overall Height:	37.8mm
Arm Length:	56.9mm
Underarm Height:	25.1mm
Holding Force:	90daN

Other Features

Arm Opens:	85°
Handle Opens:	73°
Weight:	0.13Kg

Material

Toggle Clamp:	304 Stainless Steel
Handle:	uPVC
Spindle:	304 Stainless Steel
Flanged Washers:	304 Stainless Steel

Whats In The Bag?

Toggle Clamp:	GH-201-BSS
Spindle:	SA-064010-SS
Flanged Washers:	FW-140-SS

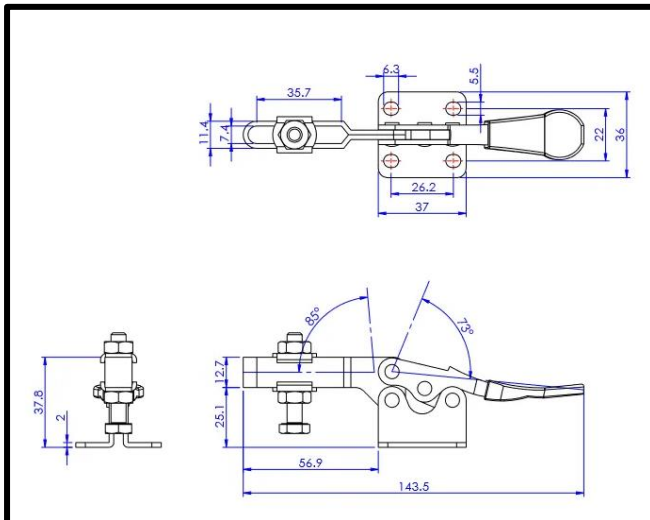

goodhanduk.co.uk

01908 221 151