

Vertical Toggle Clamp

Part No. GH-12502-A

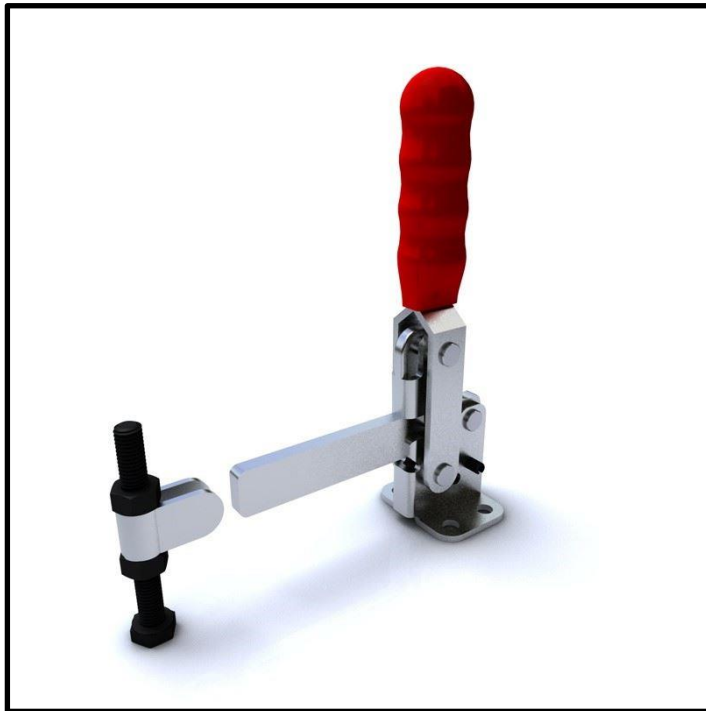

Product Description

Vertical Toggle Clamp Flat Base
Fixed Arm Size 250Kg

Key Features

Overall Height: 178mm
Underarm Height: 32mm
Arm Length: 71.5mm
Holding Force: 250Kg

Other Features

Arm Opens: 90°
Handle Opens: 70°
Weight: 0.44Kg

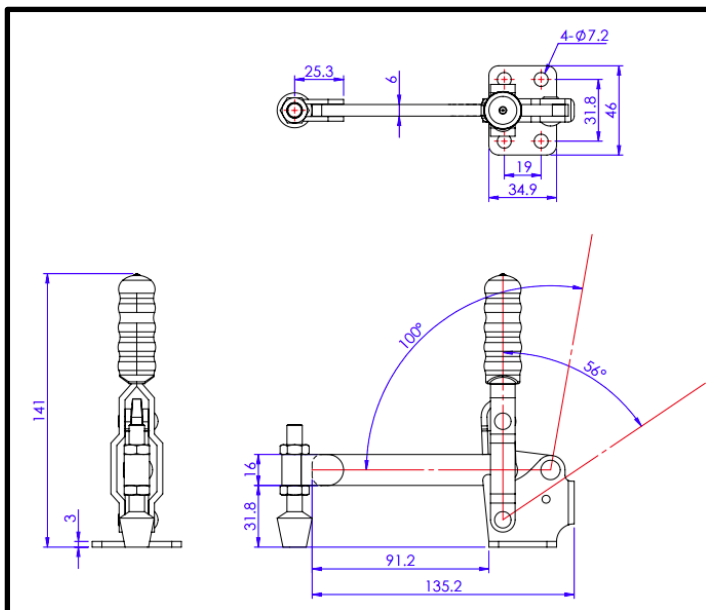

Material

Clamp: Zinc Plated Mild Steel
Spindle: Zinc Plated Mild Steel
Handle: uPVC
Bolt Retainer: Zinc Plated Mild Steel

What's In The Bag?

GH-12502-A: Toggle Clamp
SA-086012: M8x60mm Zinc Plated Steel Spindle
With Nuts
BR-516: Bolt Retainer For M8 Spindle



goodhanduk.co.uk

01908 221 151