

# Knurled torque knobs

## Item description/product images

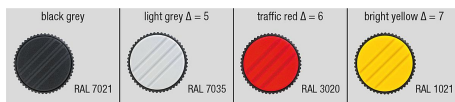

## Description

### Material:

Thermoplastic, black grey.  
Bush and screw steel 5.8.

### Version:

Bush black oxidised.  
Screw trivalent blue passivated.

### Note:

The set screw sets the required torque. The knob de-clutches and turns freely when the desired torque is reached.

### Drawing reference:

1) adjusting screw for setting the torque

## Drawings

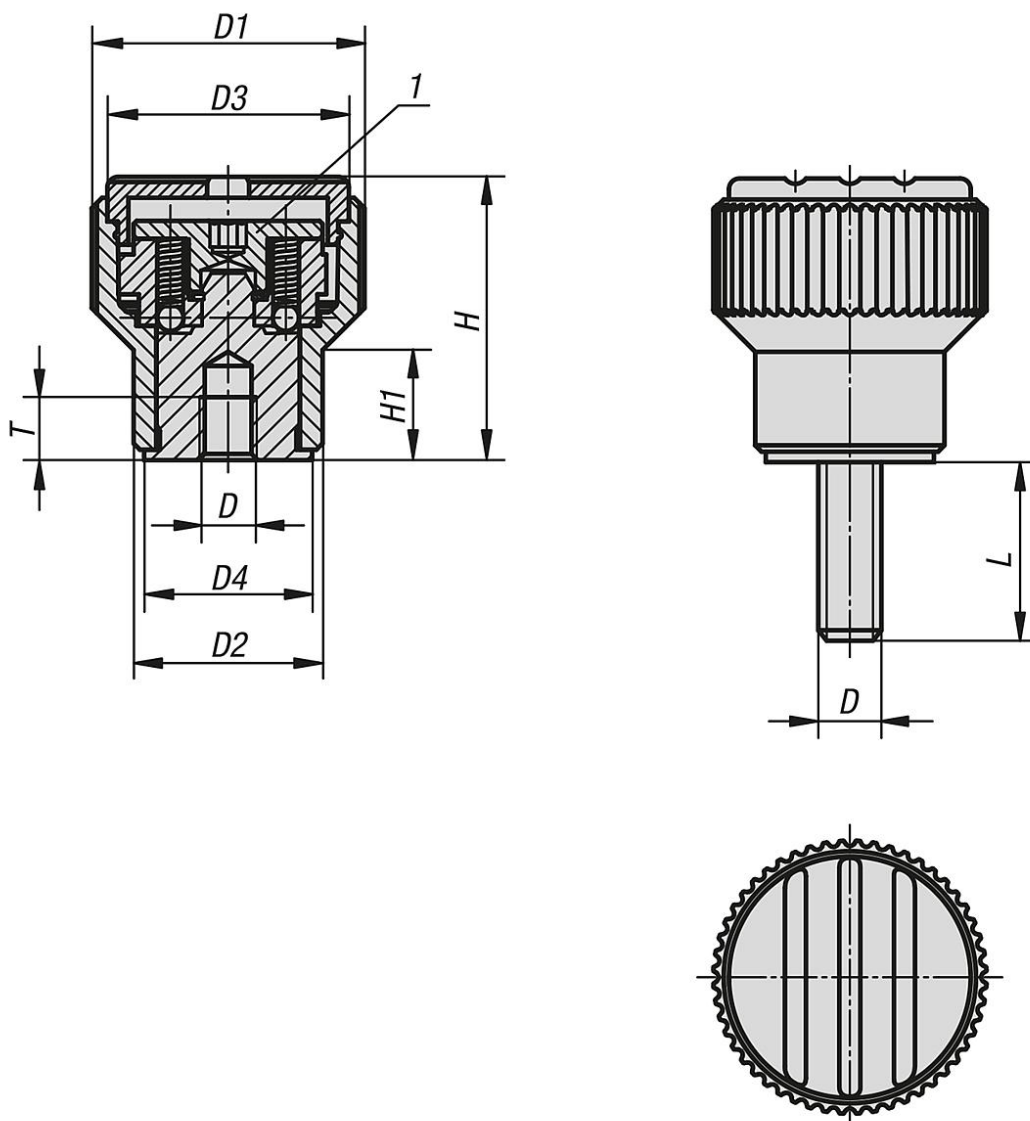

## Knurled torque knobs

### Overview of items

#### Knurled torque knobs with internal thread

Order No.	Component material	D	D1	D2	D3	D4	H	H1	T	Torque Nm
K0277.205Δ	steel	M5	26	18	23	16	27	10,5	5	0,1 - 0,3
K0277.206Δ	steel	M6	26	18	23	16	27	10,5	6	0,1 - 0,3
K0277.306Δ	steel	M6	34	22	31	20	37,5	14,5	10	0,1 - 0,3
K0277.308Δ	steel	M8	34	22	31	20	37,5	14,5	14	0,1 - 0,3

#### Knurled torque knobs with external thread

Order No.	Component material	D	D1	D2	D3	D4	H	H1	L	Torque Nm
K0277.205ΔX	steel	M5	26	18	23	16	27	10,5	30/50	0,1 - 0,3
K0277.206ΔX	steel	M6	26	18	23	16	27	10,5	30/50	0,1 - 0,3
K0277.306ΔX	steel	M6	34	22	31	20	37,5	14,5	40/60	0,1 - 0,3
K0277.308ΔX	steel	M8	34	22	31	20	37,5	14,5	40/60	0,1 - 0,3