

Vertical Toggle Clamp

Part No. GH-12265-SS



Product Description

Stainless Steel Vertical Toggle Clamp Flat Base Size 340daN

Key Features

Overall Height: 206mm
Underarm Height: 44mm
Arm Length: 83.5mm
Holding Force: 340daN

Other Features

Arm Opens: 112°
Handle Opens: 61°
Weight: 0.635Kg

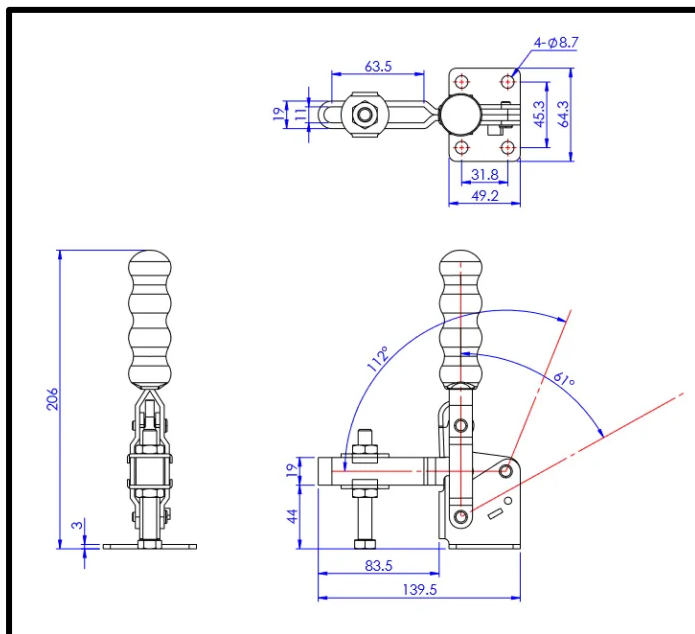

Material

Toggle Clamp: 304 Stainless Steel
Spindle: 304 Stainless Steel
Handle: uPVC

What's In The Bag?

GH-12265-SS: Toggle Clamp
FW-380-SS: 2x Flanged Washers for M10 Spindle
SA-107515-SS: M10x75mm Stainless Spindle With Nuts



goodhanduk.co.uk

01908 221 151