

► Straight Base All Arm Types

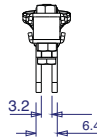

Part No:	GH-201-I
Holding Force:	38Kg
Arm Opens:	90°
Handle Opens:	80°
Weight:	0.05Kg
Spindle Supplied:	SA-08034
Flanged Washers Supplied:	FW-080

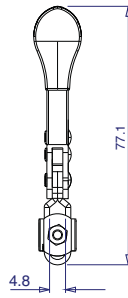
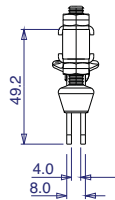
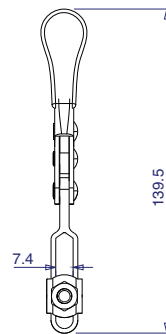
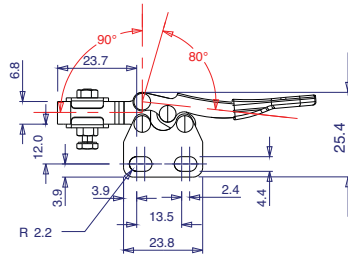

Part No:	GH-201-BI
Holding Force:	90Kg
Arm Opens:	85°
Handle Opens:	60°
Weight:	0.13Kg
Spindle Supplied:	FC-14134
Flanged Washers Supplied:	FW-141

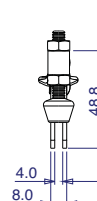
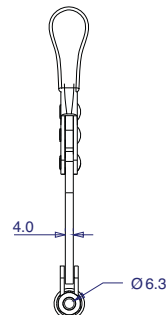
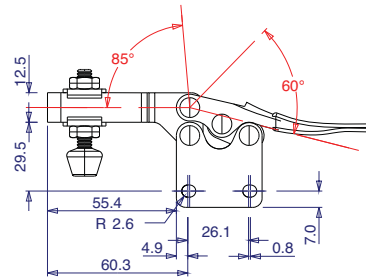

Part No:	GH-201-BSI
Holding Force:	90Kg
Arm Opens:	85°
Handle Opens:	60°
Weight:	0.13Kg
Spindle Supplied:	FC-14134
Bolt Retainer Supplied:	BR-516

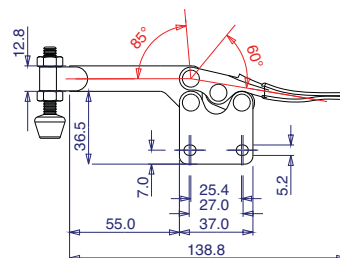

► Straight Base All Arm Types

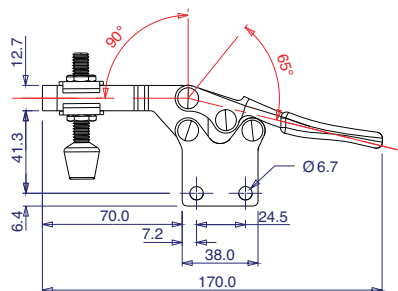
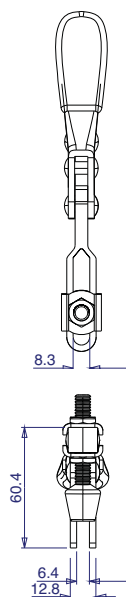

Part No:	GH-225-DI
Holding Force:	227Kg
Arm Opens:	90°
Handle Opens:	65°
Weight:	0.27Kg
Spindle Supplied:	FC-56212
Flanged Washers Supplied:	FW-516

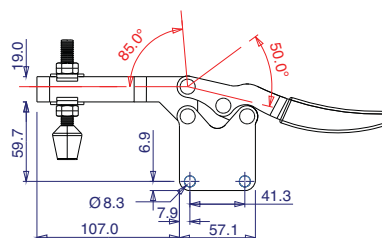
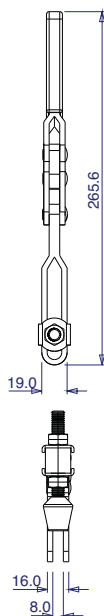

Part No:	GH-20236
Holding Force:	340Kg
Arm Opens:	85°
Handle Opens:	50°
Weight:	0.64Kg
Spindle Supplied:	FC-38312
Flanged Washers Supplied:	FW-380

