

Push-Pull Toggle Clamp

Part No. GH-36092M

GH GoodHand UK

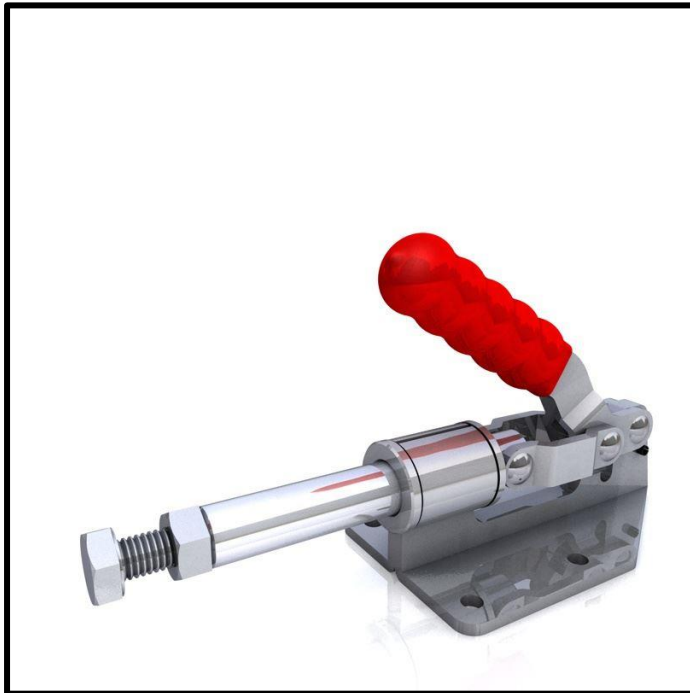

Product Description

Push Pull Toggle Clamp Plunger
Stroke 31.8mm Size 180Kg

Key Features

Overall Height: 84.5mm
Length: 140.8mm
Stroke: 31.8mm
Holding Force: 180Kg

Other Features

Arm Opens: 180°
Weight: 0.384Kg

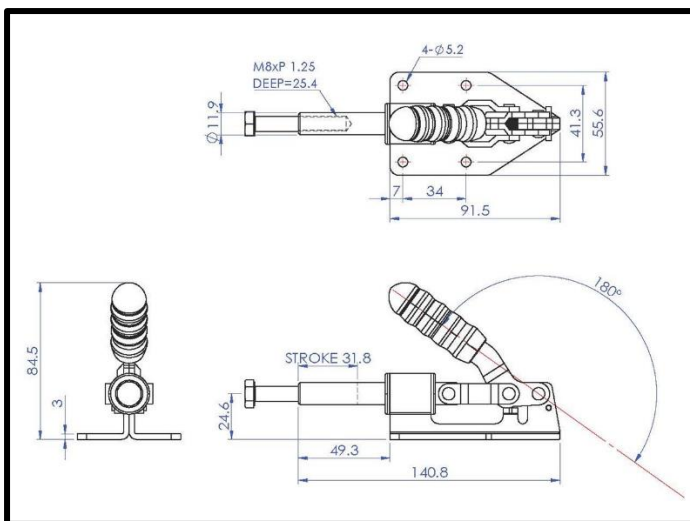

Material

Clamp: Zinc Plated Mild Steel
Spindle: Zinc Plated Mild Steel
Handle: uPVC

What's In The Bag?

GH-36092M: Toggle Clamp
SA-085012: M8x50 Zinc Plated Steel Spindle
With Nut

GH GoodHand UK

goodhanduk.co.uk

01908 221 151