

# Push-Pull Toggle Clamp

Part No. GH-30250M

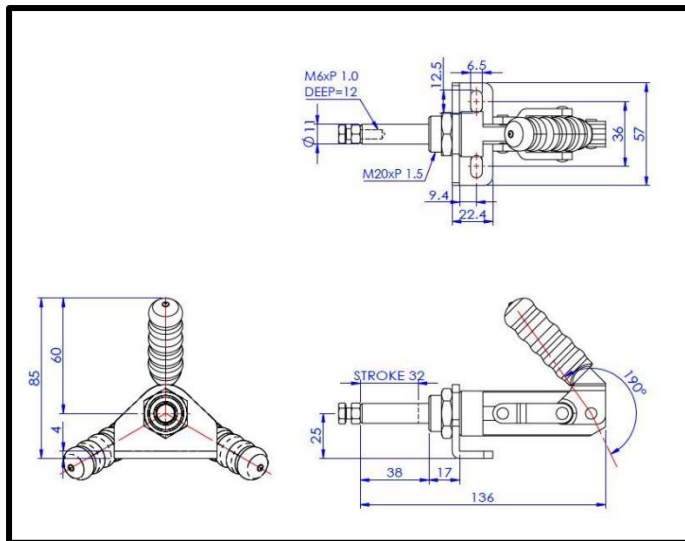

## Product Description

Push Pull Toggle Clamp Plunger  
Stroke 32mm Size 250Kg

## Key Features

Overall Height: 85mm  
Length: 136mm  
Stroke: 32mm  
Holding Force: 250Kg

## Other Features

Arm Opens: 190°  
Weight: 0.384Kg

## Material

Clamp: Zinc Plated Mild Steel  
Spindle: Zinc Plated Mild Steel  
Handle: uPVC

## What's In The Bag?

GH-30250M: Toggle Clamp  
SA-062010: M6x20mm Zinc Plated Steel Spindle  
With Nut



[goodhanduk.co.uk](http://goodhanduk.co.uk)

01908 221 151