

Horizontal Toggle Clamp

Part No. GH-201-SS

GH GoodHand UK

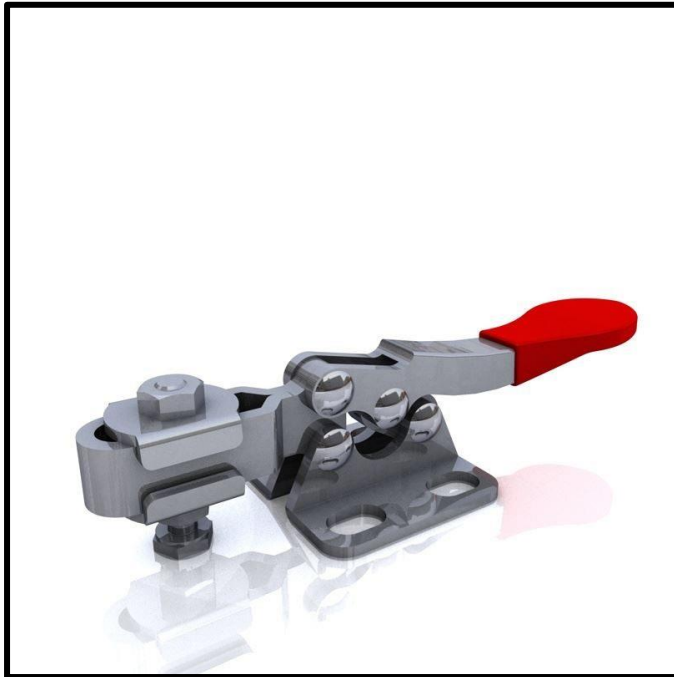

Product Description

Stainless Steel Horizontal Clamp
Flat Base Size 27daN

Key Features

Overall Height:	17.3mm
Underarm Height:	7.7mm
Arm Length:	20.7mm
Holding Force:	27daN

Other Features

Arm Opens	90°
Handle Opens	75°
Weight:	0.03Kg

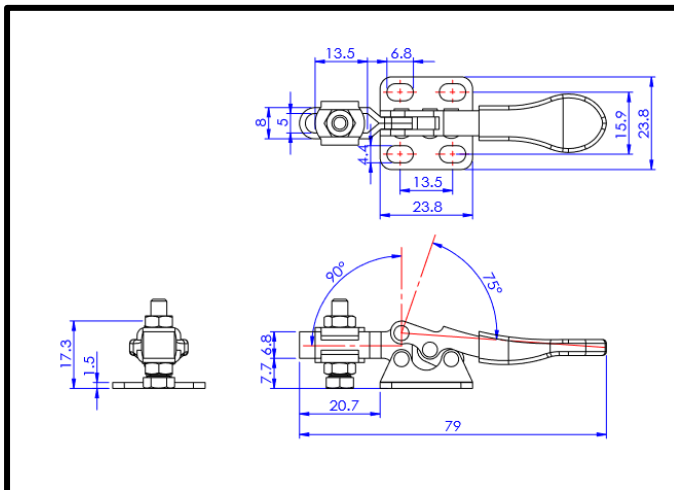

Material

Toggle Clamp:	304 Stainless Steel
Spindle:	304 Stainless Steel
Handle:	uPVC
Flanged Washers:	304 Stainless Steel

What's In The Bag?

Toggle Clamp:	GH-201-SS
Spindle:	SA-042007-SS
Flanged Washers:	2x FW-080-SS

GH GoodHand UK

goodhanduk.co.uk

01908 221 151

Horizontal Toggle Clamp

Part No. GH-201-SS



goodhanduk.co.uk

01908 221 151