

Push-Pull Toggle Clamp

Part No. GH-36080



Product Description

Push Pull Toggle Clamp Plunger
Stroke 80mm Size 305Kg

Key Features

Overall Height: 139mm
Length: 236mm
Stroke: 80mm
Holding Force: 305Kg

Other Features

Arm Opens: 180°
Weight: 1Kg

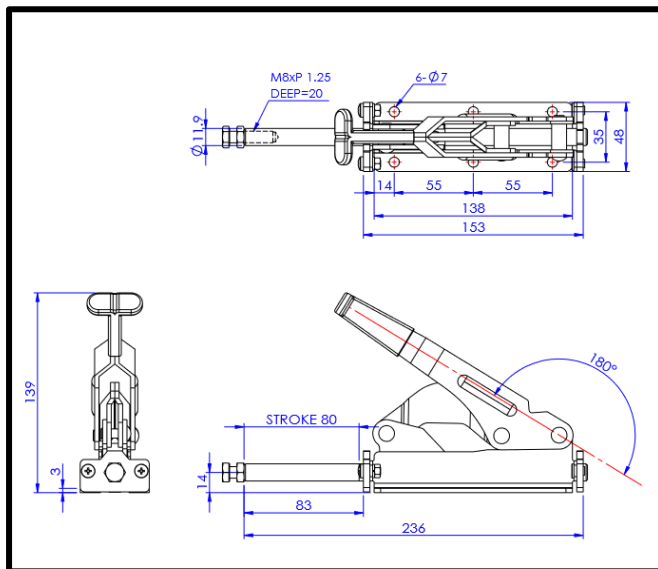

Material

Clamp: Zinc Plated Mild Steel
Spindle: Zinc Plated Mild Steel
Handle: uPVC

What's In The Bag?

GH-36080: Toggle Clamp
SA-083012: M8x30mm Zinc Plated Steel Spindle
With Nut



goodhanduk.co.uk

01908 221 151