

Horizontal Toggle Clamp
Part No. GH-23501-A

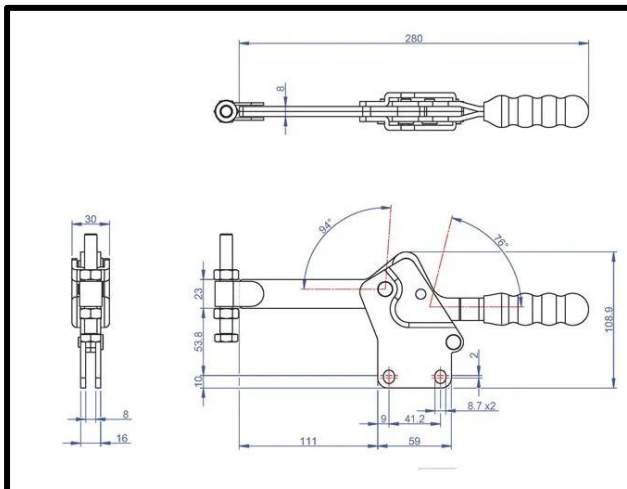
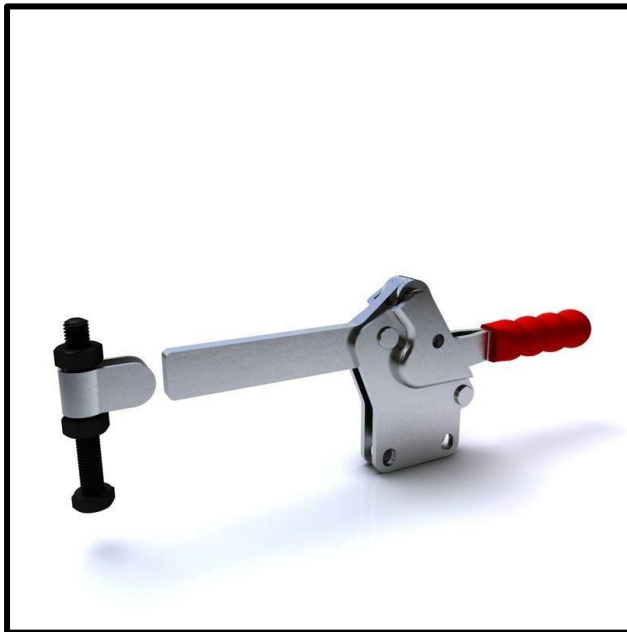

Product Description

Horizontal Toggle Clamp Straight
Base Solid Arm Size 350daN

Key Features

Overall Height: 108.9mm
Underarm Height: 53.8mm
Arm Length: 111mm
Holding Force: 350daN

Other Features

Arm Opens: 94°
Handle Opens: 76°
Weight: 0.97Kg

Material

Toggle Clamp: Zinc Plated Mild Steel
Spindle: Zinc Plated Mild Steel
Handle: uPVC
Bolt Retainer: Zinc Plated Mild Steel

Whats In The Bag?

Toggle Clamp: GH-23501-A
Spindle: SA-108015
Bolt Retainer: BR-380



goodhanduk.co.uk

01908 221 151