

Horizontal Toggle Clamp
Part No. GH-201-AL



Product Description

Horizontal Toggle Clamp Left
Hand Base Fixed Arm Size 27daN

Key Features

Overall Height:	18.7mm
Underarm Height:	11.1mm
Arm Length:	18mm
Holding Force:	27daN

Other Features

Arm Opens:	90°
Handle Opens:	75°
Weight:	0.03Kg

Material

Toggle Clamp:	Zinc Plated Mild Steel
Spindle:	Nylon
Handle:	uPVC

Whats In The Bag?

Toggle Clamp:	GH-201-AL
Spindle:	SA-08034

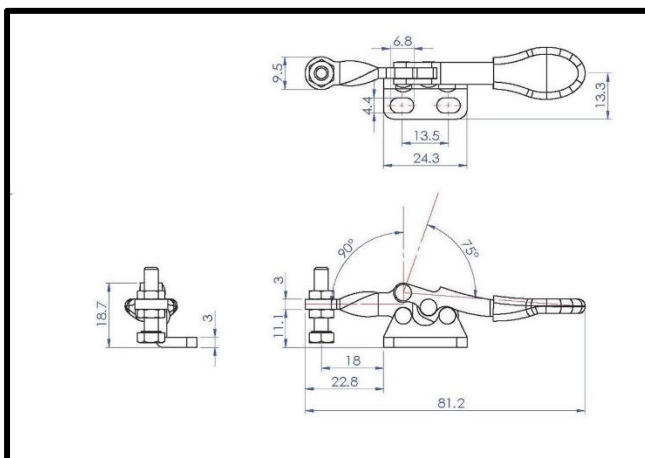

goodhanduk.co.uk

01908 221 151