

Push-Pull Toggle Clamp

Part No. GH-305-HM

GH GoodHand UK



Product Description

Push Pull Toggle Clamp Plunger
Stroke 60.4mm Size 680Kg

Key Features

Overall Height: 174mm
Length: 235.6mm
Stroke: 60mm
Holding Force: 680Kg

Other Features

Arm Opens: 183°
Weight: 1.429Kg

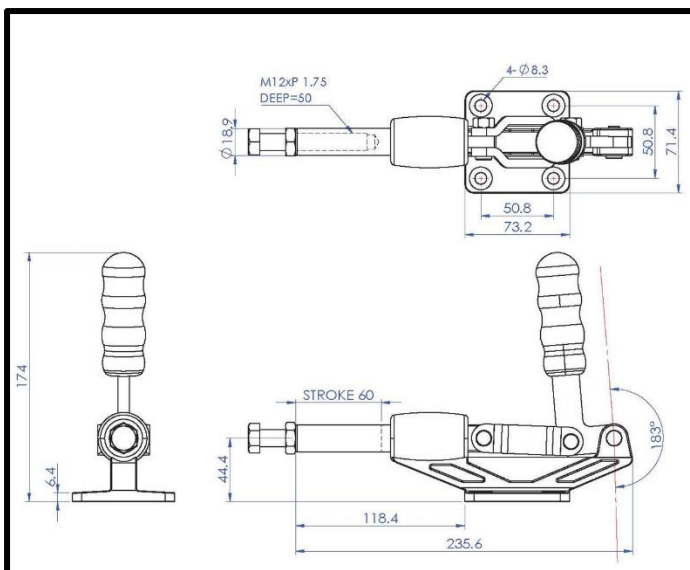

Material

Clamp: Zinc Plated Mild Steel
Spindle: Zinc Plated Mild Steel
Handle: uPVC

What's In The Bag?

GH-305-HM: Toggle Clamp
SA-125017: M12x50mm Zinc Plated Steel Spindle
With Nut

GH GoodHand UK

goodhanduk.co.uk

01908 221 151