

# Push-Pull Toggle Clamp

Part No. GH-36003M



## Product Description

Push Pull Toggle Clamp Plunger  
Stroke 31.8mm Size 272Kg

## Key Features

Overall Height: 85mm  
Length: 125mm  
Stroke: 31.8mm  
Holding Force: 272Kg

## Other Features

Arm Opens: 180°  
Weight: 0.383Kg

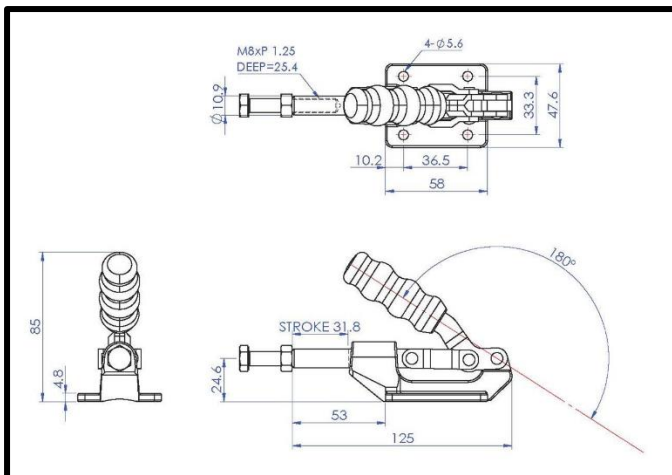

## Material

Clamp: Zinc Plated Mild Steel  
Spindle: Zinc Plated Mild Steel  
Handle: uPVC

## What's In The Bag?

GH-36003M: Toggle Clamp  
SA-085012: M8x50mm Zinc Plated Steel Spindle  
With Nut



[goodhanduk.co.uk](http://goodhanduk.co.uk)

01908 221 151