

Push-Pull Toggle Clamp

Part No. GH-301-AM

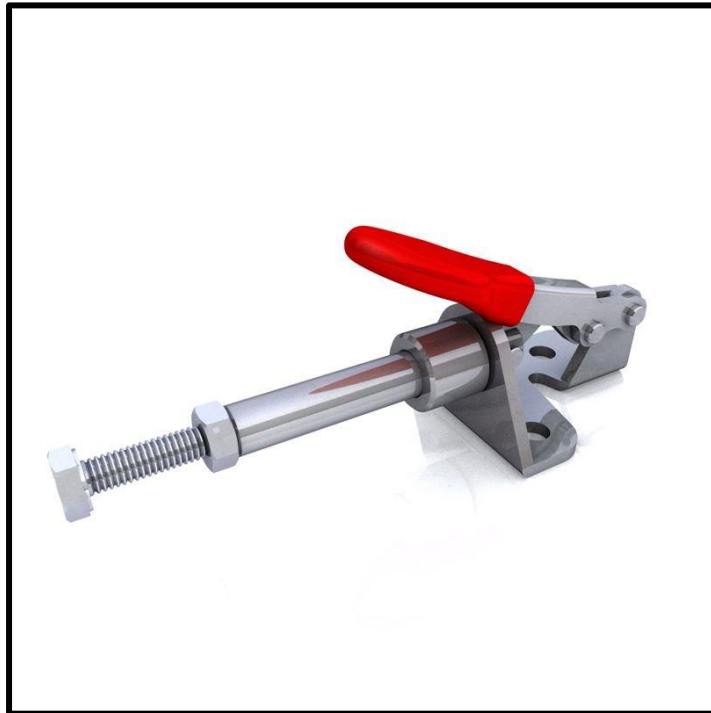

Product Description

Push Pull Toggle Clamp Plunger
Stroke 16mm Size 45Kg

Key Features

Overall Height: 43.5mm
Length: 67.9mm
Stroke: 17mm
Holding Force: 45Kg

Other Features

Arm Opens: 190°
Weight: 0.04Kg

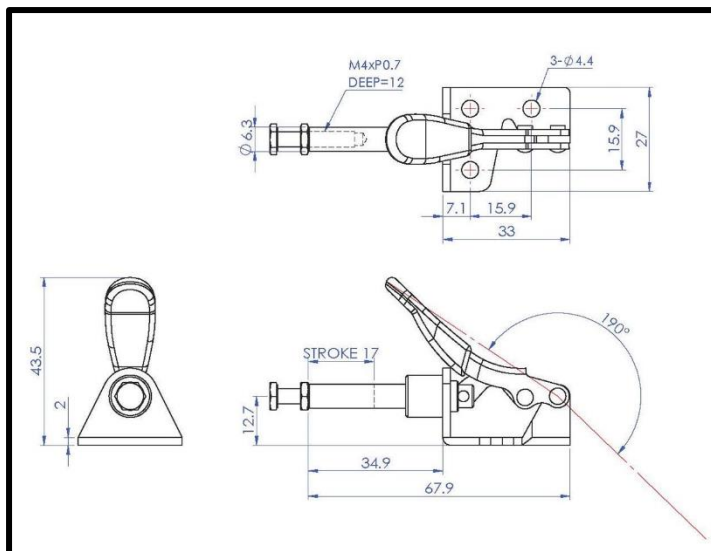

Material

Clamp: Zinc Plated Mild Steel
Spindle: Nylon
Handle: uPVC

What's In The Bag?

GH-301-AM: Toggle Clamp
SA-042007: M4x20 Nylon Spindle With Zinc Plated Steel Nut



goodhanduk.co.uk

01908 221 151