

# Horizontal Toggle Clamp

Part No. GH-225-DSS



## Product Description

Stainless Steel Horizontal Clamp  
Flat Base Size 227daN

## Key Features

Overall Height:	47.6mm
Arm Length:	71.6mm
Underarm Height:	34.9mm
Holding Force:	227daN

## Other Features

Arm Opens:	90°
Handle Opens:	65°
Weight:	0.26Kg

## Material

Toggle Clamp:	304 Stainless Steel
Handle:	uPVC
Spindle:	304 Stainless Steel
Flanged Washers:	304 Stainless Steel

## Whats In The Bag?

Toggle Clamp:	GH-225-DSS
Spindle:	SA-085012-SS
Flanged Washers:	FW-516-SS

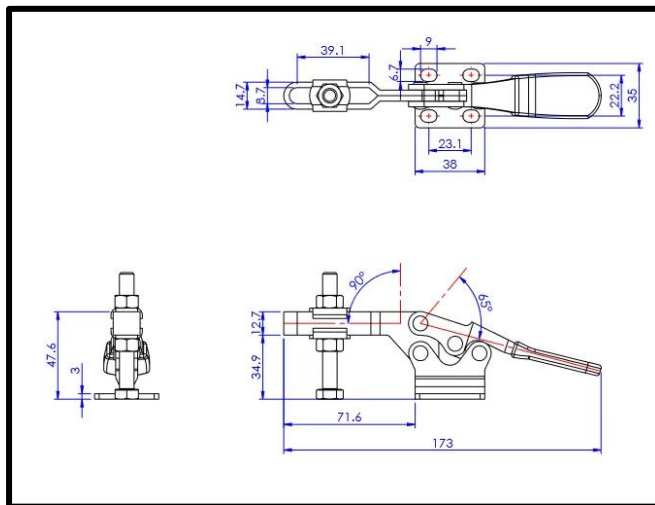

[goodhanduk.co.uk](http://goodhanduk.co.uk)

01908 221 151