

Indexing plungers

Item description/product images

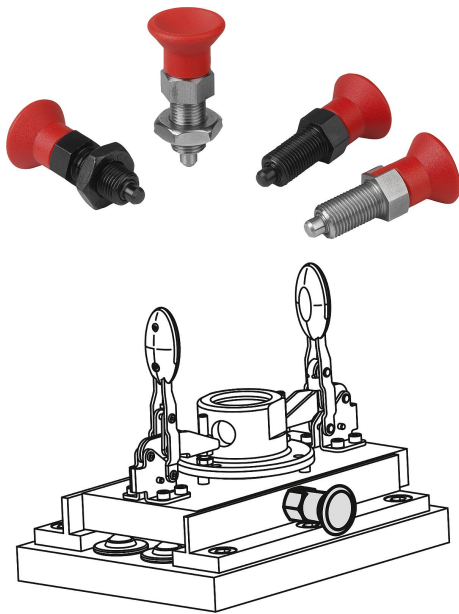

Description

Material:

Steel version
Indexing pin hardened:
grade 5.8.

Stainless steel version
Indexing pin hardened:
Threaded sleeve 1.4305
Indexing pin 1.4034

Indexing pin not hardened:
Threaded sleeve 1.4305
Indexing pin 1.4305

Mushroom knob red thermoplastic.

Version:

Steel version:
Indexing pin hardened, ground, black oxidised.

Stainless steel version:
Indexing pin hardened, ground and bright.
Indexing pin not hardened, ground and bright.

Note:

Indexing plungers are used to prevent any change in locking position due to lateral forces. A new locking position can only be set after the pin has been manually disengaged. Form C or D is recommended for applications where the plunger remains disengaged over a long period and the pin should be prevented from springing back.

On request:

Special versions.

Accessory:

Spacer rings K0665

Indexing plungers

Drawings

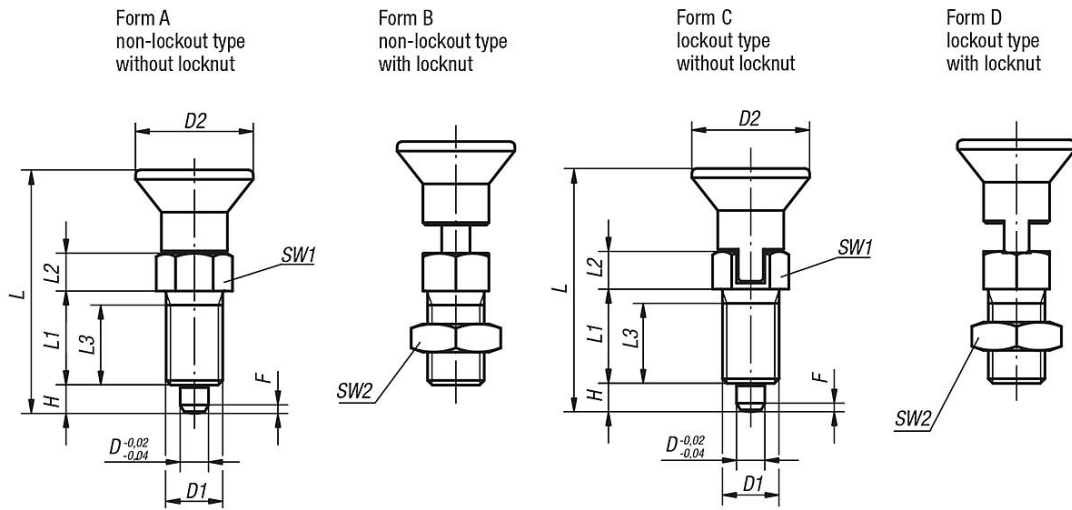

Overview of items

Indexing plungers, steel, indexing pin hardened

Order No.	Main material	Version 1	Form	D	D1	D2	L	L1	L2	L3	H	SW1	SW2	Fx30°	Spring force initial pressure F1 approx. N	Spring force final pressure F2 approx. N
K0338.190384	steel	without locking slot	A	3	M6x0,75	14	31,5	12	5	10	-	8	-	0,8	4,5	10
K0338.100484	steel	without locking slot	A	4	M8x1	18	38,5	15	6	13	-	10	-	1	6	12
K0338.110584	steel	without locking slot	A	5	M10x1	21	43,5	17	7	15	-	13	-	1,3	5	12
K0338.120684	steel	without locking slot	A	6	M12x1,5	25	51,7	20	8	17	-	14	-	1,8	6	14
K0338.130884	steel	without locking slot	A	8	M16x1,5	33	68	26	10	23	-	19	-	2,3	15	35
K0338.141084	steel	without locking slot	A	10	M20x1,5	33	74	28	12	25	-	22	-	2,8	15	34
K0338.141284	steel	without locking slot	A	12	M20x1,5	33	78	28	14	25	-	22	-	2,8	15	39
K0338.151684	steel	without locking slot	A	16	M24x2	40	96	32	18	28	-	27	-	3,2	20	46
K0338.0190384	stainless steel	without locking slot	A	3	M6x0,75	14	31,5	12	5	10	-	8	-	0,8	4,5	10
K0338.0100484	stainless steel	without locking slot	A	4	M8x1	18	38,5	15	6	13	-	10	-	1	6	12
K0338.0110584	stainless steel	without locking slot	A	5	M10x1	21	43,5	17	7	15	-	13	-	1,3	5	12
K0338.0120684	stainless steel	without locking slot	A	6	M12x1,5	25	51,7	20	8	17	-	14	-	1,8	6	14
K0338.0130884	stainless steel	without locking slot	A	8	M16x1,5	33	68	26	10	23	-	19	-	2,3	15	35
K0338.0141084	stainless steel	without locking slot	A	10	M20x1,5	33	74	28	12	25	-	22	-	2,8	15	34
K0338.0141284	stainless steel	without locking slot	A	12	M20x1,5	33	78	28	14	25	-	22	-	2,8	15	39
K0338.0151684	stainless steel	without locking slot	A	16	M24x2	40	96	32	18	28	-	27	-	3,2	20	46
K0338.1190384	stainless steel	without locking slot	A	3	M6x0,75	14	31,5	12	5	10	-	8	-	0,8	4,5	10
K0338.1100484	stainless steel	without locking slot	A	4	M8x1	18	38,5	15	6	13	-	10	-	1	6	12
K0338.1110584	stainless steel	without locking slot	A	5	M10x1	21	43,5	17	7	15	-	13	-	1,3	5	12
K0338.1120684	stainless steel	without locking slot	A	6	M12x1,5	25	51,7	20	8	17	-	14	-	1,8	6	14
K0338.1130884	stainless steel	without locking slot	A	8	M16x1,5	33	68	26	10	23	-	19	-	2,3	15	35
K0338.1141084	stainless steel	without locking slot	A	10	M20x1,5	33	74	28	12	25	-	22	-	2,8	15	34
K0338.1141284	stainless steel	without locking slot	A	12	M20x1,5	33	78	28	14	25	-	22	-	2,8	15	39
K0338.1151684	stainless steel	without locking slot	A	16	M24x2	40	96	32	18	28	-	27	-	3,2	20	46
K0338.290384	steel	without locking slot	B	3	M6x0,75	14	31,5	12	5	10	-	8	10	0,8	4,5	10
K0338.200484	steel	without locking slot	B	4	M8x1	18	38,5	15	6	13	-	10	13	1	6	12
K0338.210584	steel	without locking slot	B	5	M10x1	21	43,5	17	7	15	-	13	17	1,3	5	12
K0338.220684	steel	without locking slot	B	6	M12x1,5	25	51,7	20	8	17	-	14	19	1,8	6	14
K0338.230884	steel	without locking slot	B	8	M16x1,5	33	68	26	10	23	-	19	24	2,3	15	35
K0338.241084	steel	without locking slot	B	10	M20x1,5	33	74	28	12	25	-	22	30	2,8	15	34
K0338.241284	steel	without locking slot	B	12	M20x1,5	33	78	28	14	25	-	22	30	2,8	15	39
K0338.251684	steel	without locking slot	B	16	M24x2	40	96	32	18	28	-	27	36	3,2	20	46
K0338.0290384	stainless steel	without locking slot	B	3	M6x0,75	14	31,5	12	5	10	-	8	10	0,8	4,5	10
K0338.0200484	stainless steel	without locking slot	B	4	M8x1	18	38,5	15	6	13	-	10	13	1	6	12
K0338.0210584	stainless steel	without locking slot	B	5	M10x1	21	43,5	17	7	15	-	13	17	1,3	5	12
K0338.0220684	stainless steel	without locking slot	B	6	M12x1,5	25	51,7	20	8	17	-	14	19	1,8	6	14

Indexing plungers

Overview of items

Order No.	Main material	Version 1	Form	D	D1	D2	L	L1	L2	L3	H	SW1	SW2	Fx30°	Spring force initial pressure F1 approx. N	Spring force final pressure F2 approx. N
K0338.0230884	stainless steel	without locking slot	B	8	M16x1,5	33	68	26	10	23	-	19	24	2,3	15	35
K0338.0241084	stainless steel	without locking slot	B	10	M20x1,5	33	74	28	12	25	-	22	30	2,8	15	34
K0338.0241284	stainless steel	without locking slot	B	12	M20x1,5	33	78	28	14	25	-	22	30	2,8	15	39
K0338.0251684	stainless steel	without locking slot	B	16	M24x2	40	96	32	18	28	-	27	36	3,2	20	46
K0338.1290384	stainless steel	without locking slot	B	3	M6x0,75	14	31,5	12	5	10	-	8	10	0,8	4,5	10
K0338.1200484	stainless steel	without locking slot	B	4	M8x1	18	38,5	15	6	13	-	10	13	1	6	12
K0338.1210584	stainless steel	without locking slot	B	5	M10x1	21	43,5	17	7	15	-	13	17	1,3	5	12
K0338.1220684	stainless steel	without locking slot	B	6	M12x1,5	25	51,7	20	8	17	-	14	19	1,8	6	14
K0338.1230884	stainless steel	without locking slot	B	8	M16x1,5	33	68	26	10	23	-	19	24	2,3	15	35
K0338.1241084	stainless steel	without locking slot	B	10	M20x1,5	33	74	28	12	25	-	22	30	2,8	15	34
K0338.1241284	stainless steel	without locking slot	B	12	M20x1,5	33	78	28	14	25	-	22	30	2,8	15	39
K0338.1251684	stainless steel	without locking slot	B	16	M24x2	40	96	32	18	28	-	27	36	3,2	20	46
K0338.390384	steel	with locking slot	C	3	M6x0,75	14	31,5	12	5	10	-	8	-	0,8	4,5	10
K0338.300484	steel	with locking slot	C	4	M8x1	18	38,5	15	6	13	-	10	-	1	6	12
K0338.310584	steel	with locking slot	C	5	M10x1	21	43,5	17	7	15	-	13	-	1,3	5	12
K0338.320684	steel	with locking slot	C	6	M12x1,5	25	51,7	20	8	17	-	14	-	1,8	6	14
K0338.330884	steel	with locking slot	C	8	M16x1,5	33	68	26	10	23	-	19	-	2,3	15	35
K0338.341084	steel	with locking slot	C	10	M20x1,5	33	74	28	12	25	-	22	-	2,8	15	34
K0338.341284	steel	with locking slot	C	12	M20x1,5	33	78	28	14	25	-	22	-	2,8	15	39
K0338.351684	steel	with locking slot	C	16	M24x2	40	96	32	18	28	-	27	-	3,2	20	46
K0338.0390384	stainless steel	with locking slot	C	3	M6x0,75	14	31,5	12	5	10	-	8	-	0,8	4,5	10
K0338.0300484	stainless steel	with locking slot	C	4	M8x1	18	38,5	15	6	13	-	10	-	1	6	12
K0338.0310584	stainless steel	with locking slot	C	5	M10x1	21	43,5	17	7	15	-	13	-	1,3	5	12
K0338.0320684	stainless steel	with locking slot	C	6	M12x1,5	25	51,7	20	8	17	-	14	-	1,8	6	14
K0338.0330884	stainless steel	with locking slot	C	8	M16x1,5	33	68	26	10	23	-	19	-	2,3	15	35
K0338.0341084	stainless steel	with locking slot	C	10	M20x1,5	33	74	28	12	25	-	22	-	2,8	15	34
K0338.0341284	stainless steel	with locking slot	C	12	M20x1,5	33	78	28	14	25	-	22	-	2,8	15	39
K0338.0351684	stainless steel	with locking slot	C	16	M24x2	40	96	32	18	28	-	27	-	3,2	20	46
K0338.1390384	stainless steel	with locking slot	C	3	M6x0,75	14	31,5	12	5	10	-	8	-	0,8	4,5	10
K0338.1300484	stainless steel	with locking slot	C	4	M8x1	18	38,5	15	6	13	-	10	-	1	6	12
K0338.1310584	stainless steel	with locking slot	C	5	M10x1	21	43,5	17	7	15	-	13	-	1,3	5	12
K0338.1320684	stainless steel	with locking slot	C	6	M12x1,5	25	51,7	20	8	17	-	14	-	1,8	6	14
K0338.1330884	stainless steel	with locking slot	C	8	M16x1,5	33	68	26	10	23	-	19	-	2,3	15	35
K0338.1341084	stainless steel	with locking slot	C	10	M20x1,5	33	74	28	12	25	-	22	-	2,8	15	34
K0338.1341284	stainless steel	with locking slot	C	12	M20x1,5	33	78	28	14	25	-	22	-	2,8	15	39
K0338.1351684	stainless steel	with locking slot	C	16	M24x2	40	96	32	18	28	-	27	-	3,2	20	46
K0338.490384	steel	with locking slot	D	3	M6x0,75	14	31,5	12	5	10	-	8	10	0,8	4,5	10
K0338.400484	steel	with locking slot	D	4	M8x1	18	38,5	15	6	13	-	10	13	1	6	12
K0338.410584	steel	with locking slot	D	5	M10x1	21	43,5	17	7	15	-	13	17	1,3	5	12
K0338.420684	steel	with locking slot	D	6	M12x1,5	25	51,7	20	8	17	-	14	19	1,8	6	14
K0338.430884	steel	with locking slot	D	8	M16x1,5	33	68	26	10	23	-	19	24	2,3	15	35
K0338.441084	steel	with locking slot	D	10	M20x1,5	33	74	28	12	25	-	22	30	2,8	15	34
K0338.441284	steel	with locking slot	D	12	M20x1,5	33	78	28	14	25	-	22	30	2,8	15	39
K0338.451684	steel	with locking slot	D	16	M24x2	40	96	32	18	28	-	27	36	3,2	20	46
K0338.0490384	stainless steel	with locking slot	D	3	M6x0,75	14	31,5	12	5	10	-	8	10	0,8	4,5	10
K0338.0400484	stainless steel	with locking slot	D	4	M8x1	18	38,5	15	6	13	-	10	13	1	6	12
K0338.0410584	stainless steel	with locking slot	D	5	M10x1	21	43,5	17	7	15	-	13	17	1,3	5	12
K0338.0420684	stainless steel	with locking slot	D	6	M12x1,5	25	51,7	20	8	17	-	14	19	1,8	6	14
K0338.0430884	stainless steel	with locking slot	D	8	M16x1,5	33	68	26	10	23	-	19	24	2,3	15	35
K0338.0441084	stainless steel	with locking slot	D	10	M20x1,5	33	74	28	12	25	-	22	30	2,8	15	34
K0338.0441284	stainless steel	with locking slot	D	12	M20x1,5	33	78	28	14	25	-	22	30	2,8	15	39
K0338.0451684	stainless steel	with locking slot	D	16	M24x2	40	96	32	18	28	-	27	36	3,2	20	46
K0338.1490384	stainless steel	with locking slot	D	3	M6x0,75	14	31,5	12	5	10	-	8	10	0,8	4,5	10
K0338.1400484	stainless steel	with locking slot	D	4	M8x1	18	38,5	15	6	13	-	10	13	1	6	12
K0338.1410584	stainless steel	with locking slot	D	5	M10x1	21	43,5	17	7	15	-	13	17	1,3	5	12
K0338.1420684	stainless steel	with locking slot	D	6	M12x1,5	25	51,7	20	8	17	-	14	19	1,8	6	14
K0338.1430884	stainless steel	with locking slot	D	8	M16x1,5	33	68	26	10	23	-	19	24	2,3	15	35
K0338.1441084	stainless steel	with locking slot	D	10	M20x1,5	33	74	28	12	25	-	22	30	2,8	15	34
K0338.1441284	stainless steel	with locking slot	D	12	M20x1,5	33	78	28	14	25	-	22	30	2,8	15	39
K0338.1451684	stainless steel	with locking slot	D	16	M24x2	40	96	32	18	28	-	27	36	3,2	20	46

