

Vertical Toggle Clamp

Part No. GH-12265

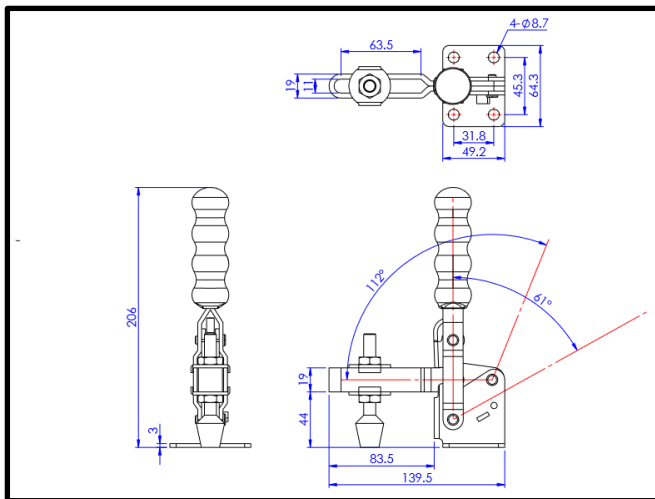

Product Description

Vertical Toggle Clamp Flat Base
Slotted Arm Size 340Kg

Key Features

Overall Height: 206mm
Underarm Height: 44mm
Arm Length: 83.5mm
Holding Force: 340Kg

Other Features

Arm Opens: 112°
Handle Opens: 61°
Weight: 0.65Kg

Material

Clamp: Zinc Plated Mild Steel
Spindle: Neoprene Tipped Steel
Handle: uPVC

What's In The Bag?

GH-12265: Toggle Clamp
2x FW-380: Flanged Washers For 10mm Spindle
FC-108515: M10x85mm Neoprene Tipped Steel
Spindle With Nuts