

# Push-Pull Toggle Clamp

Part No. GH-36010M

**GH GoodHand UK**



## Product Description

Push Pull Toggle Clamp Plunger  
Stroke 41.3mm Size 364Kg

## Key Features

Overall Height: 122mm  
Length: 171.3mm  
Stroke: 41.3mm  
Holding Force: 364Kg

## Other Features

Arm Opens: 180°  
Weight: 0.802Kg

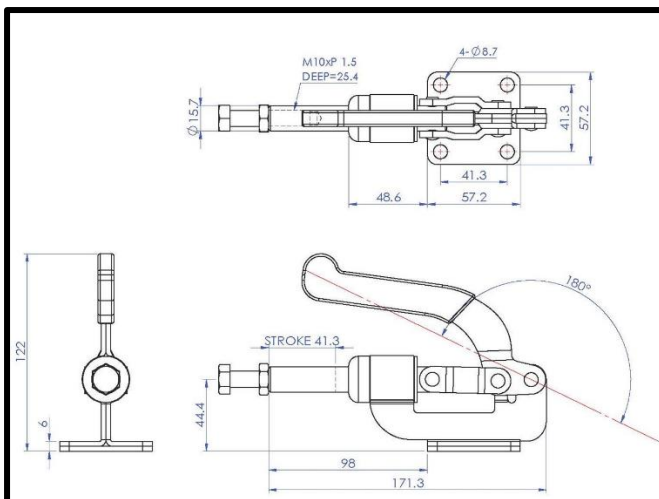

## Material

Clamp: Zinc Plated Mild Steel  
Spindle: Zinc Plated Mild Steel  
Handle: uPVC

## What's In The Bag?

GH-36010M: Toggle Clamp  
SA-105015: M10x50mm Zinc Plated Steel Spindle  
With Nut

**GH GoodHand UK**

[goodhanduk.co.uk](http://goodhanduk.co.uk)

01908 221 151