

Thrust screws with point

Item description/product images



Description

Material:

Screw steel grade 10.9.

Pin tool steel.

Version:

Pin, hardened.

Screw and pin black oxidised.

Note:

These thrust screws with point are used when additional positive fixation is required.

Drawings

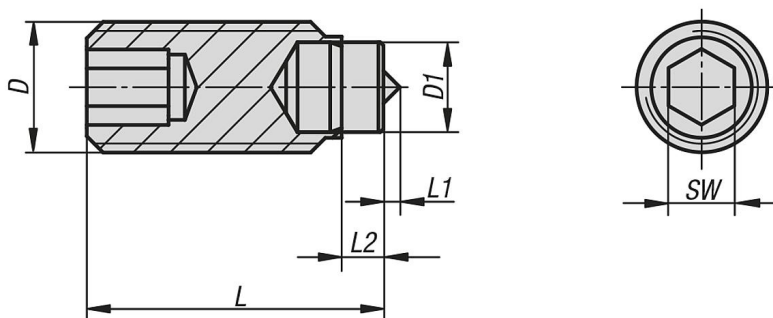

Overview of items

Order No.	D	D1	L	L1	L2	SW	Load rating max. kN (static load only)
K0272.05X09	M5	3	8,5	0,5	1,3	2,5	4,5
K0272.05X13	M5	3	12,5	0,5	1,3	2,5	4,5
K0272.05X17	M5	3	16,5	0,5	1,3	2,5	4,5
K0272.05X21	M5	3	20,5	0,5	1,3	2,5	4,5
K0272.06X14	M6	4	13,5	0,8	1,9	3	9
K0272.06X18	M6	4	17,5	0,8	1,9	3	9
K0272.06X22	M6	4	21,5	0,8	1,9	3	9

Thrust screws with point

Overview of items

Order No.	D	D1	L	L1	L2	SW	Load rating max. kN (static load only)
K0272.06X27	M6	4	26,5	0,8	1,9	3	9
K0272.08X14	M8	5,5	14	1	2,4	4	15
K0272.08X18	M8	5,5	18	1	2,4	4	15
K0272.08X22	M8	5,5	22	1	2,4	4	15
K0272.08X27	M8	5,5	27	1	2,4	4	15
K0272.08X34	M8	5,5	34	1	2,4	4	15
K0272.10X18	M10	7	18	1,5	2,6	5	20
K0272.10X22	M10	7	22	1,5	2,6	5	20
K0272.10X27	M10	7	27	1,5	2,6	5	20
K0272.10X34	M10	7	34	1,5	2,6	5	20
K0272.10X42	M10	7	42	1,5	2,6	5	20