

# Push-Pull Toggle Clamp

Part No. GH-301-AMSS



## Product Description

Stainless Steel Push Pull Clamp Plunger  
Stroke 16mm Size 45daN

## Key Features

Overall Height: 43.5mm  
Length: 67.9mm  
Stroke: 16mm  
Holding Force: 45Kg

## Other Features

Arm Opens: 190°  
Weight: 0.05Kg

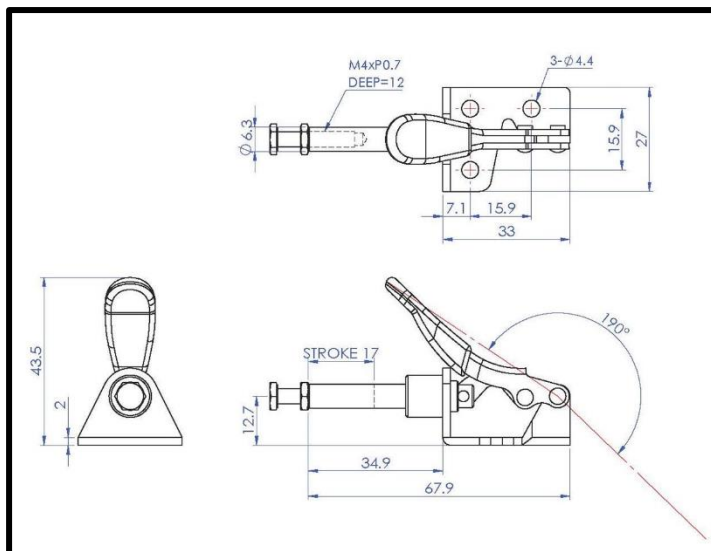

## Material

Clamp: Stainless Steel  
Spindle: Stainless Steel  
Handle: uPVC

## What's In The Bag?

GH-301-AM: Toggle Clamp  
SA-042007-SS: M4x20 Stainless Spindle With Nuts



[goodhanduk.co.uk](http://goodhanduk.co.uk)

01908 221 151