

# Push-Pull Toggle Clamp

Part No. GH-30750M

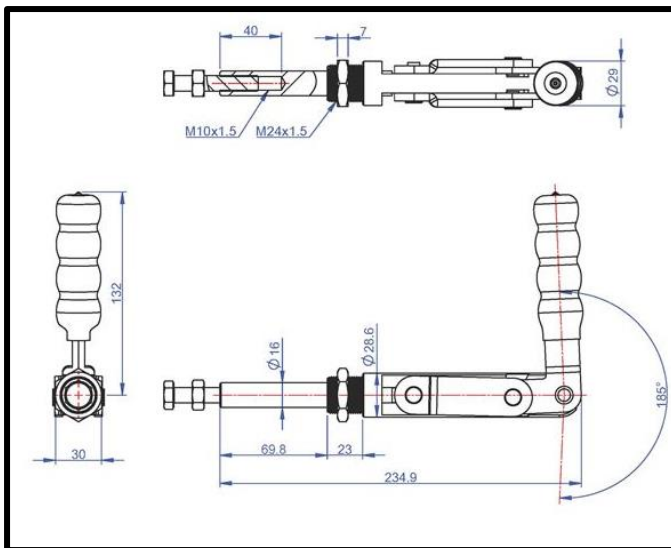
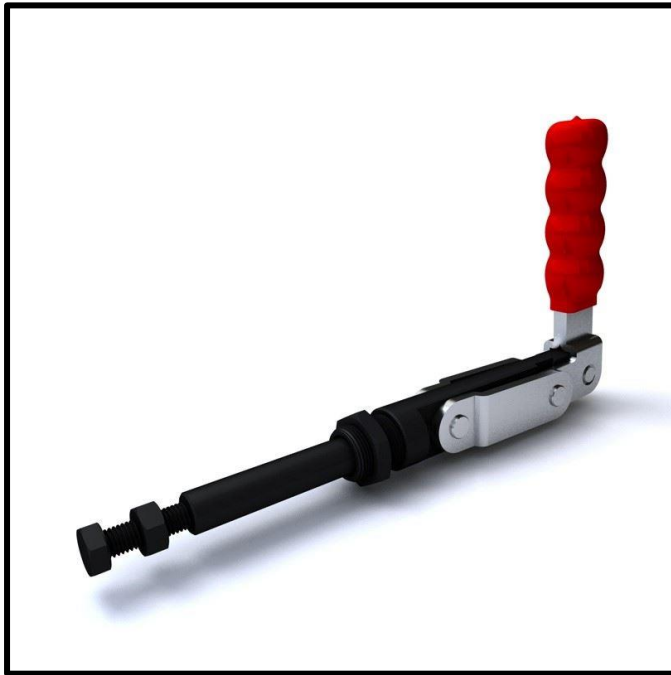

## Product Description

Push Pull No Mounting Bracket  
Stroke 66mm Size 750kg

## Key Features

Overall Height: 132mm  
Length: 234.9mm  
Stroke: 66mm  
Holding Force: 550Kg

## Other Features

Arm Opens: 185°  
Weight: 0.95Kg

## Material

Clamp: Zinc Plated Mild Steel  
Spindle: Zinc Plated Mild Steel  
Handle: uPVC

## What's In The Bag?

GH-30750M: Toggle Clamp  
SA-105015: M10x50mm Zinc Plated Steel Spindle  
With Nut



[goodhanduk.co.uk](http://goodhanduk.co.uk)

01908 221 151