

Vertical Toggle Clamp

Part No. GH-101-EL



Product Description

Vertical Toggle Clamp Flat Base
Slotted Arm Size 360Kg

Key Features

Overall Height: 232mm
Underarm Height: 47mm
Arm Length: 84.6mm
Holding Force: 360Kg

Other Features

Arm Opens: 90°
Handle Opens: 60°
Weight: 0.83Kg

Material

Clamp: Zinc Plated Mild Steel
Spindle: Neoprene Tipped Steel
Handle: uPVC

What's In The Bag?

GH-101-EL: Toggle Clamp
2x FW-380: Flanged Washers For 10mm Spindle
FC-108515: M10x85mm Neoprene Tipped Steel
Spindle With Nuts

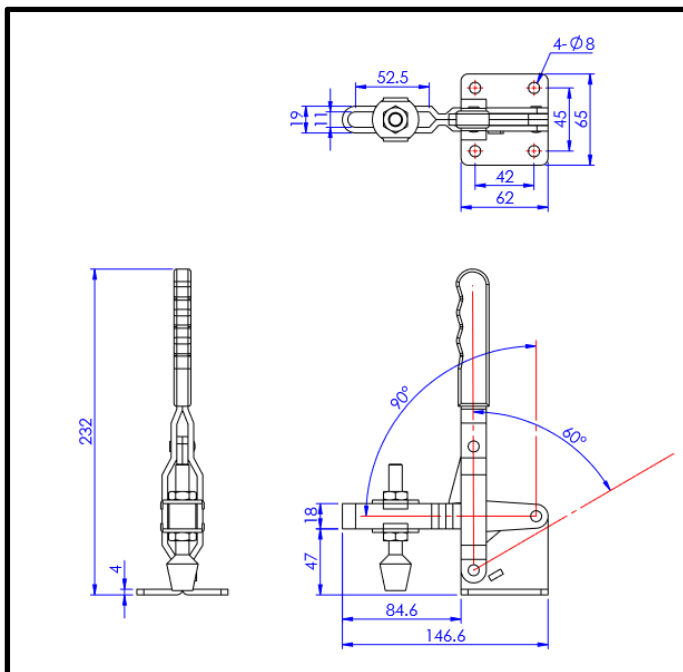

goodhanduk.co.uk

01908 221 151

Vertical Toggle Clamp

Part No. GH-101-EL



goodhanduk.co.uk

01908 221 151