

# Horizontal Toggle Clamp

Part No. GH-201-I

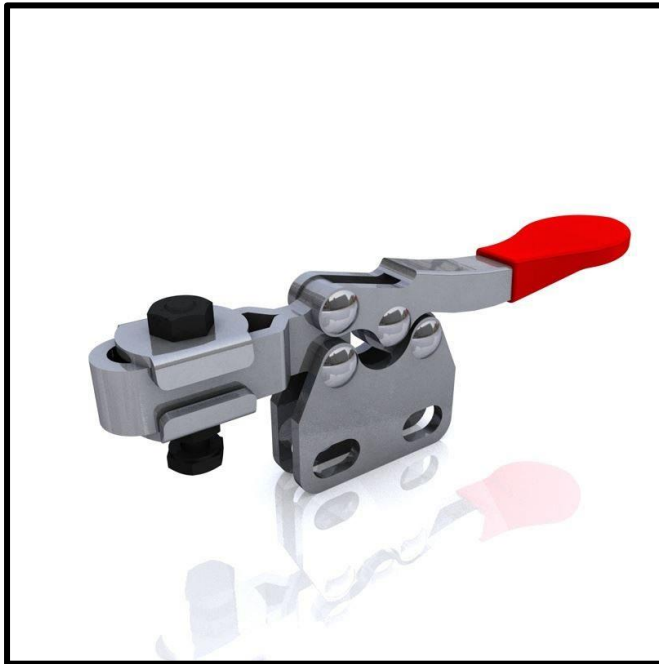

## Product Description

Horizontal Toggle Clamp Straight  
Base Slotted Arm Size 27daN

## Key Features

Overall Height:	25.3mm
Underarm Height:	15.7mm
Arm Length:	20.7mm
Holding Force:	27daN

## Other Features

Arm Opens:	90°
Handle Opens:	75°
Weight:	0.03Kg

## Material

Toggle Clamp:	Zinc Plated Mild Steel
Spindle:	Nylon
Handle:	uPVC

## Whats In The Bag?

Toggle Clamp:	GH-201-I
Spindle:	SA-08034
2x Flanged Washers:	FW-080

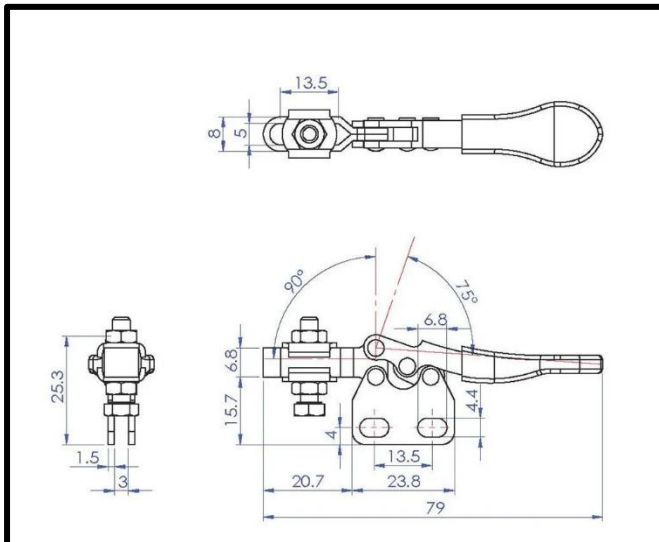

[goodhanduk.co.uk](http://goodhanduk.co.uk)

01908 221 151