

Vertical Toggle Clamp

Part No. GH-101-B

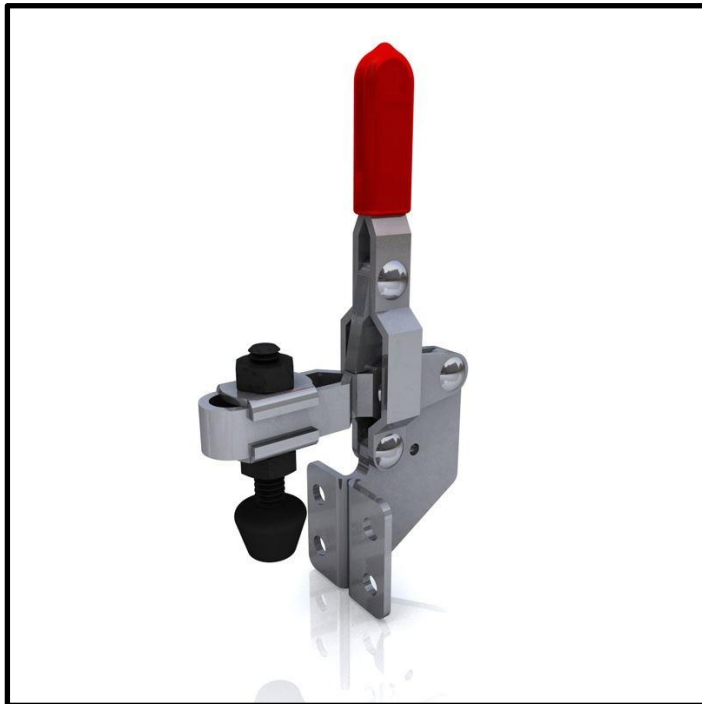

Product Description

Vertical Toggle Clamp Side
Mounting Slotted Arm Size 100Kg

Key Features

Overall Height: 117mm
Underarm Height: 44.8mm
Arm Length: 34.8mm
Holding Force: 100Kg

Other Features

Arm Opens: 90°
Handle Opens: 65°
Weight: 0.131Kg

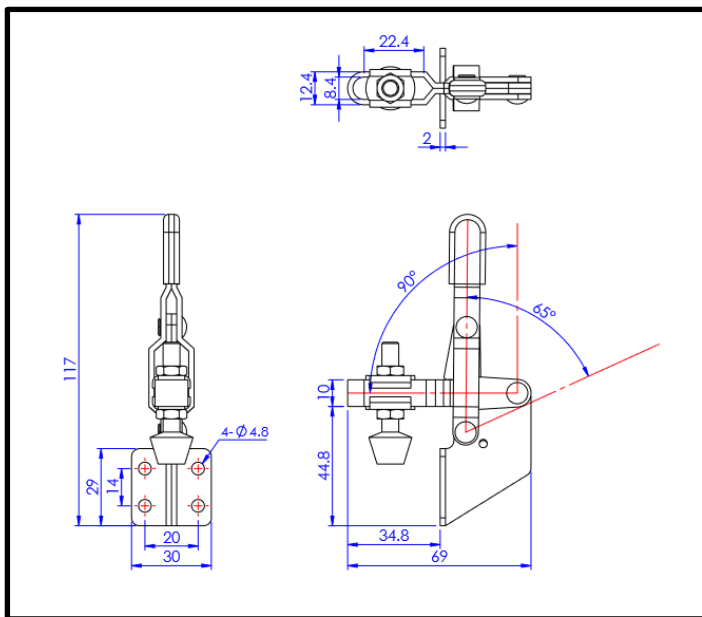

Material

Clamp: Zinc Plated Mild Steel
Spindle: Neoprene Tipped Steel
Handle: uPVC

What's In The Bag?

GH-101-B: Toggle Clamp
2x FW-142: Flanged Washer for M6 Spindle
FC-064410: M6x44mm Neoprene Tipped Spindle
With Nuts



goodhanduk.co.uk

01908 221 151