

Horizontal Toggle Clamp

Part No. GH-24501-B

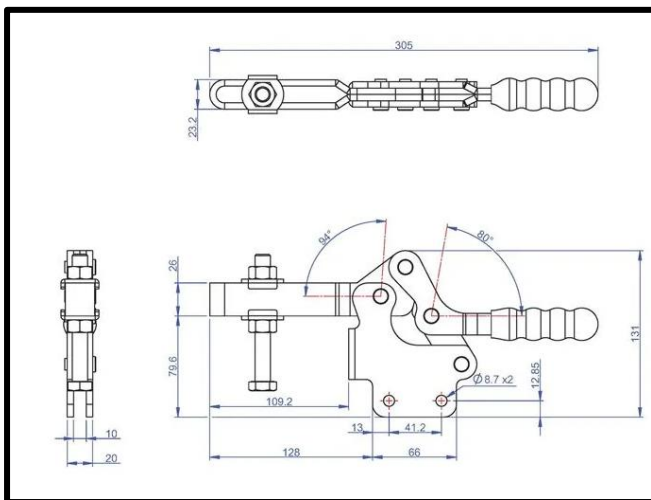
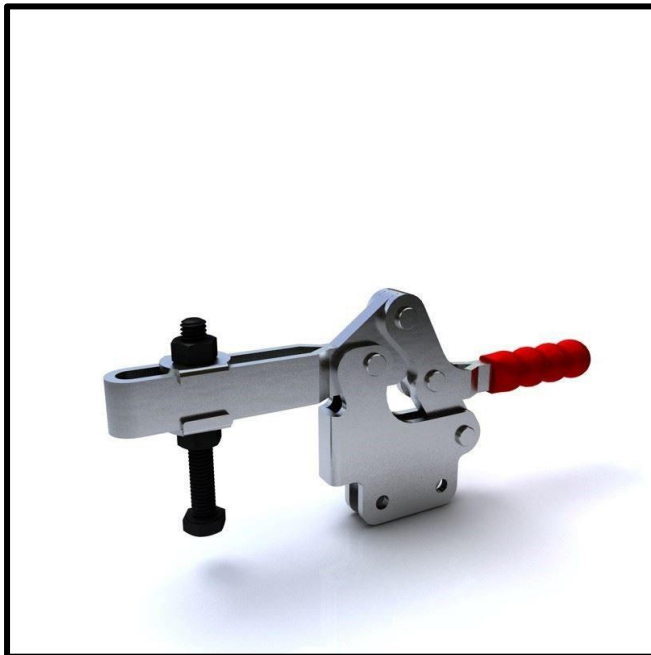

Product Description

Horizontal Toggle Clamp Straight
Base Slotted Arm Size 450daN

Key Features

Overall Height: 131mm
Underarm Height: 79.6mm
Arm Length: 109.2mm
Holding Force: 450daN

Other Features

Arm Opens: 94°
Handle Opens: 80°
Weight: 1.46Kg

Material

Toggle Clamp: Zinc Plated Mild Steel
Spindle: Zinc Plated Mild Steel
Handle: uPVC

Whats In The Bag?

Toggle Clamp: GH-24501-B
Spindle: SA-121017
2x Flanged Washers: FW-120



goodhanduk.co.uk

01908 221 151