

Horizontal Toggle Clamp Part No. GH-22501-A

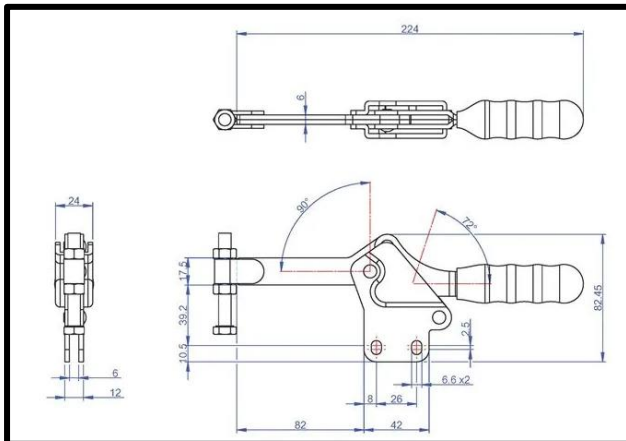
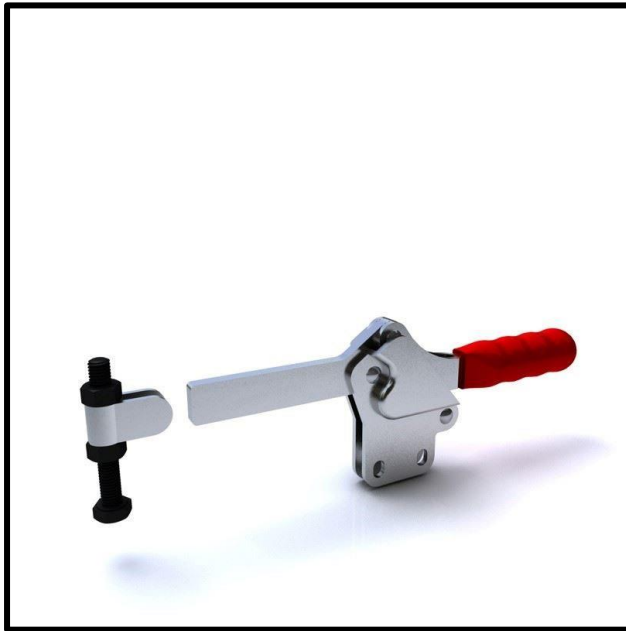

Product Description

Horizontal Toggle Clamp Straight
Base Solid Arm Size 250daN

Key Features

Overall Height: 82.45mm
Underarm Height: 39.2mm
Arm Length: 82mm
Holding Force: 250daN

Other Features

Arm Opens: 90°
Handle Opens: 72°
Weight: 0.47Kg

Material

Toggle Clamp: Zinc Plated Mild Steel
Spindle: Zinc Plated Mild Steel
Handle: uPVC
Bolt Retainer: Zinc Plated Mild Steel

Whats In The Bag?

Toggle Clamp: GH-22501-A
Spindle: SA-086012
Bolt Retainer: BR-516



goodhanduk.co.uk

01908 221 151