

# Vertical Toggle Clamp

Part No. GH-10444

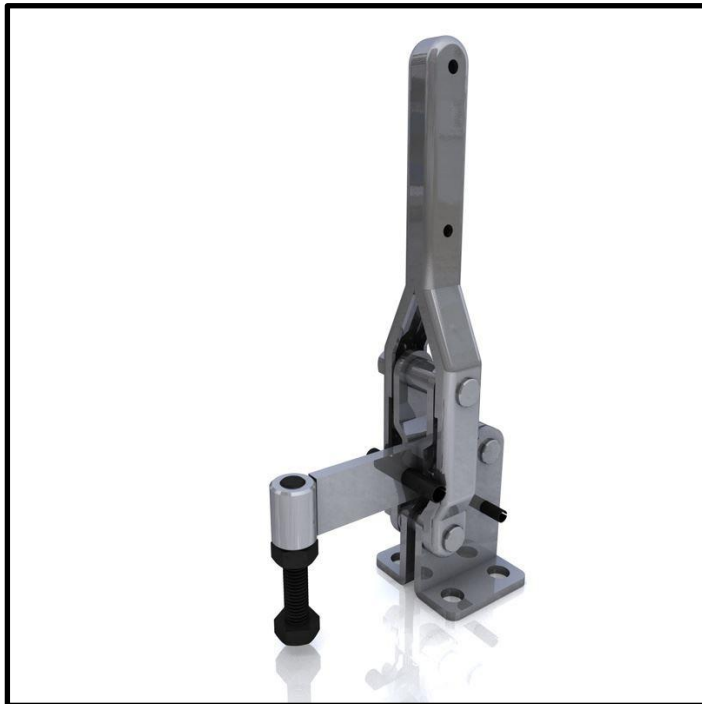

## Product Description

Vertical Toggle Clamp Flat Base  
Fixed Arm Size 400Kg

## Key Features

Overall Height: 238mm  
Underarm Height: 50mm  
Arm Length: 61mm  
Holding Force: 400Kg

## Other Features

Arm Opens: 91°  
Handle Opens: 62°  
Weight: 0.87Kg

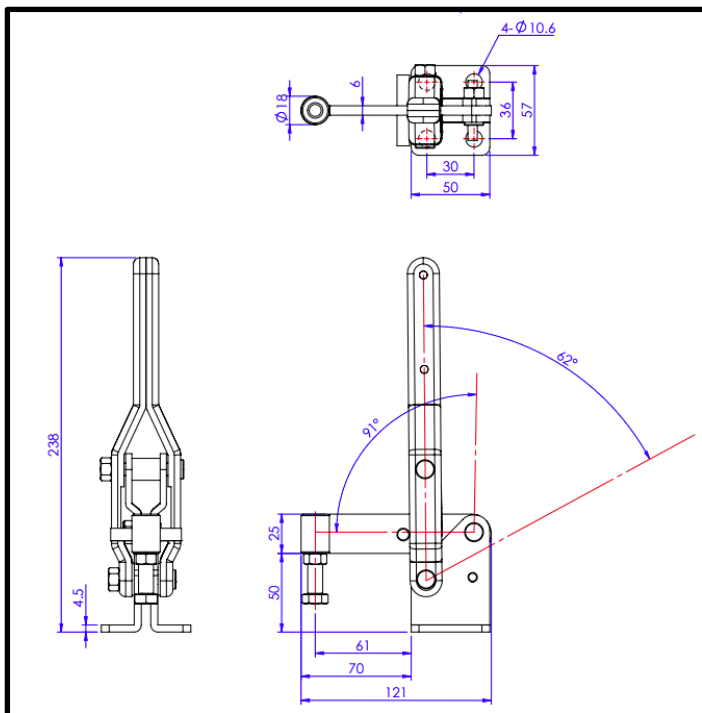

## Material

Clamp: Zinc Plated Mild Steel  
Spindle: Zinc Plated Mild Steel

## What's In The Bag?

GH-10444: Toggle Clamp  
SA-105015: M10x50mm Zinc Plated Steel Spindle  
With Nuts



[goodhanduk.co.uk](http://goodhanduk.co.uk)

01908 221 151

Vertical Toggle Clamp

Part No. GH-10444



[goodhanduk.co.uk](http://goodhanduk.co.uk)

01908 221 151