

Horizontal Toggle Clamp

Part No. GH-21502-B



Product Description

Horizontal Toggle Clamp Flat
Base Slotted Arm Size 150daN

Key Features

Overall Height:	52.1mm
Underarm Height:	25mm
Arm Length	61mm
Holding Force	150daN

Other Features

Arm Opens:	93°
Handle Opens:	76°
Weight:	0.245Kg

Material

Toggle Clamp:	Zinc Plated Mild Steel
Spindle:	Zinc Plated Mild Steel
Handle:	uPVC
Flanged Washer:	Zinc Plated Mild Steel
Cap:	Neoprene

Whats In The Bag?

Toggle Clamp:	GH-21502-B
Spindle:	SA-065010
Flanged Washers:	FW-140
Neoprene Cap:	NC-06

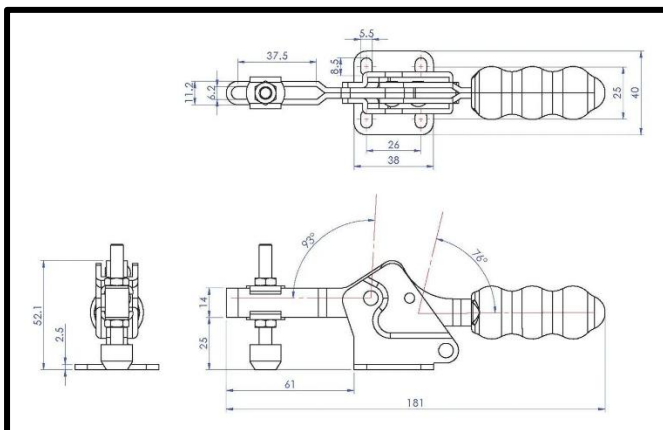

goodhanduk.co.uk

01908 221 151