

Push-Pull Toggle Clamp

Part No. GH-304-EM

GH GoodHand UK



Product Description

Push Pull Toggle Clamp Plunger
Stroke 42mm Size 386Kg

Key Features

Overall Height: 95.7mm
Length: 157.2mm
Stroke: 42mm
Holding Force: 386Kg

Other Features

Arm Opens: 183°
Weight: 0.591Kg

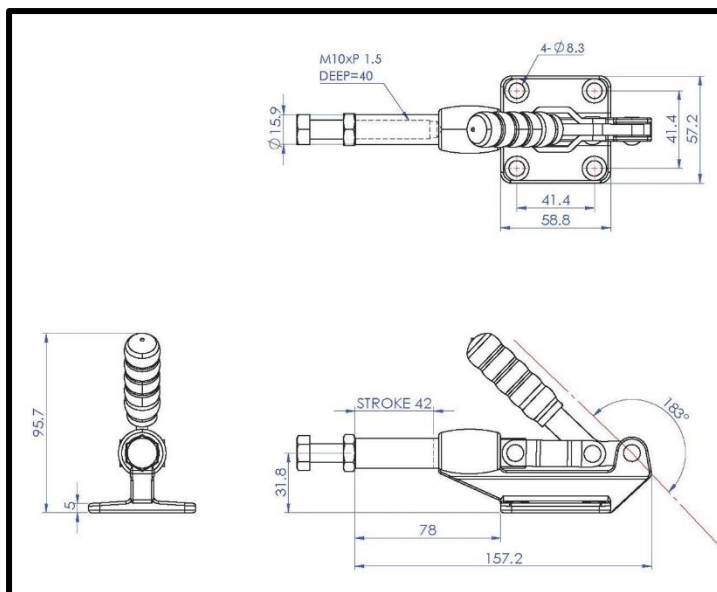

Material

Clamp: Zinc Plated Mild Steel
Spindle: Zinc Plated Mild Steel
Handle: uPVC

What's In The Bag?

GH-304-EM: Toggle Clamp
SA-105015: M10x50mm Zinc Plated Steel Spindle
With Nut

GH GoodHand UK

goodhanduk.co.uk

01908 221 151